



RAILWAYS



ROAD



ENERGY



TELECOM



SPECIAL INSTALLATIONS

LOOP INSULATOR WITH SILICONE COVER



LOOP INSULATOR 1.5 KV/AC

-60%
Montageaufwand

+80%
Lebensdauer

LOOP INSULATOR WITH SILICONE COVER

Article no. D4069-01

CONSISTENT PRODUCT INNOVATION FROM K+M

An advanced development from K+M to replace the existing version without silicone casing.

CHARACTERISTICS

These loop insulators are manufactured from resin-impregnated glass fibres. The thimbles, made of stainless steel (A4), ensure a good connection with the shackle. The loop insulator can also be used in heavily polluted ambient air and incorporates a self-cleaning effect. Another benefit: it is less vulnerable to vandalism and impacts.

APPLICATION

Contact line structure:

- ✓ One suspension element for straight sections and bends
- ✓ Cross-span
- ✓ Top tie
- ✓ Contact wire suspensions
- ✓ Contact wire-fixed terminations
- ✓ Auto-tensioned system
- ✓ Cut-in insulation in the support network or on the contact wire

General:

- ✓ Anchorage for urban lighting

INSTALLATION

The loop insulator can also be used with K+M double straps, triangular and square/rectangular plates.

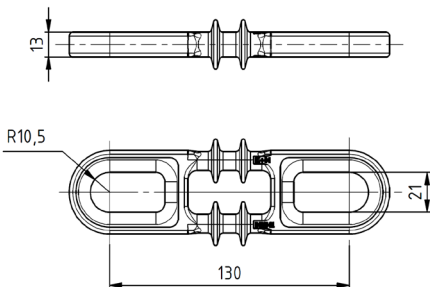

Installed loop insulator

Your benefits at a glance

- ✓ Corrosion-resistant
- ✓ Versatile applications
- ✓ Simple to install
- ✓ Can be used with the existing shackle, E0928-01
- ✓ Low weight
- ✓ Visually inconspicuous
- ✓ Can be exchanged with existing loop insulator

Specifications

- ✓ Design load:
 - With shackle E0928-01/02 54 kN
 - With bolt Ø 13/16/18 mm 48 kN
- ✓ Permitted operating load:
 - With shackle E0928-01/02 18 kN
 - With bolt Ø 13/16/18 mm 16 kN
- ✓ Maximum operating voltage 1.5 kV/DC
- ✓ Weight 0.2 kg

Tests and standards

The loop insulator was developed in compliance with the following standard:
EN 50119

Versions

Standard version, article no. **D4069-01**
as replacement for: article no. D2786-01
article no. D2864-01

Kummler+Matter Ltd
Hohlstrasse 188
8004 Zürich

T +41 44 247 47 47
F +41 44 247 47 77
info.zuerich@kuma.ch

kuma.ch

