

Slide plate type "SOD"
Schieberplatte typ "SOD"

SOD

PIASTRA TIPO "SOD"

Materiale Bronzo e Grafite
Material Bronze graphite
Material Bronze graphit

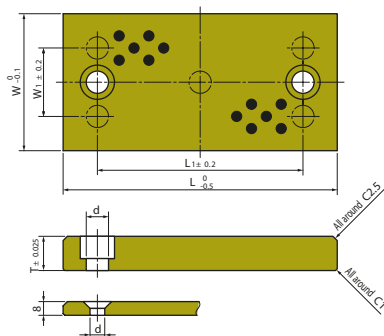

-Direzione scorrimento
-Sliding Direction
-Gleitrichtung



BRONZO E GRAFITE
Bronze graphite
Bronze graphit

Posizione fori / Hole position / loch position

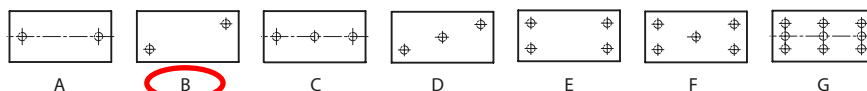

Codice	T	L	W	W1	L1	Nr. viti	Viti DIN912	Posizione fori	Direzione scorrimento
SOD-301	8	100	40	-	60	2	M8	A	S-1
SOD-302	8	160	40	-	120	2	M8	A	S-1
SOD-303	8	250	40	-	210	3	M8	C	S-1
SOD-304	12	100	30	-	60	2	M8	A	S-1
SOD-305	12	160	30	-	120	2	M8	A	S-1
SOD-306	12	250	30	-	210	3	M8	C	S-1
SOD-307	12	100	40	-	60	2	M8	A	S-1
SOD-308	12	160	40	-	120	2	M8	A	S-1
SOD-309	12	250	40	-	210	3	M8	C	S-1
SOD-310	12	100	80	40	60	2	M8	B	S-2
SOD-311	12	160	80	40	120	4	M8	E	S-2
SOD-312	12	250	80	40	210	5	M8	F	S-1
SOD-313	16	100	40	-	60	2	M10	A	S-1
SOD-314	16	160	40	-	120	2	M10	A	S-1
SOD-315	16	250	40	-	210	3	M10	C	S-1
SOD-316	16	100	60	30	60	2	M10	B	S-2
SOD-317	16	160	60	30	120	2	M10	B	S-1
SOD-318	16	250	60	30	210	3	M10	D	S-1
SOD-319	16	100	100	60	60	2	M10	B	S-2
SOD-320	16	160	100	60	120	4	M10	E	S-2
SOD-321	16	250	100	60	210	6	M10	G	S-1
SOD-322	20	100	50	20	60	2	M12	B	S-1
SOD-323	20	160	50	20	120	2	M12	B	S-1
SOD-324	20	250	50	20	210	3	M12	D	S-1
SOD-325	20	100	80	40	60	2	M12	B	S-2
SOD-326	20	160	80	40	120	4	M12	E	S-2
SOD-327	20	250	80	40	210	5	M12	F	S-1
SOD-328	20	100	125	85	60	4	M12	E	S-2
SOD-329	20	160	125	85	120	4	M12	E	S-2
SOD-330	20	250	125	85	210	6	M12	G	S-1

Esempio d'ordine: Codice
Order example:
Bestellbeispiel: